

KUPLEX® CLEVIS SLING HOOKS

The Kuplex® Clevis Sling Hook is made from premium quality high strength alloy steel and most commonly used with chain slings. The clevis end provides a safe and quick connection, while the hook offers a large throat opening and provides easy operation. Available in Grade 80 or 100, this sling hook meets the latest guidelines of the NACM and ASTM A391/A391M (Grade 80) or ASTM A973/A973M (Grade 100).



KUPLEX® CLEVIS SLING HOOKS

GRADE

- 80 and 100

FINISH

- Powder coated red

STANDARDS

- Meet the latest guidelines of the NACM and ASTM A391/A391M (Grade 80) or ASTM A973/A973M (Grade 100)

ATTACHMENT

- Clevis

HEAT TREATMENT

- Quenched and tempered before proof testing

ORIGIN

- Made in Canada

HOOK TYPE

- Sling Hook

APPLICATION

- Overhead Lifting

MATERIAL

- Premium quality, high strength alloy steel

KUPLEX® CLEVIS SLING HOOKS

DIAGRAM DRAWINGS

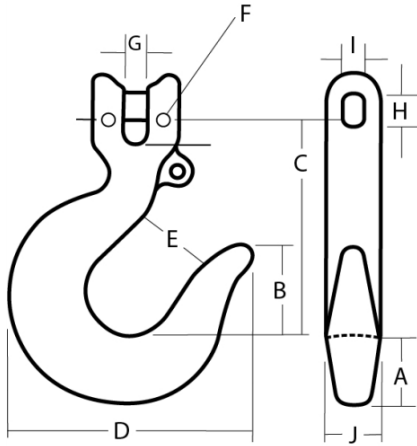

KUPLEX® CLEVIS SLING HOOKS

PRODUCTS SPECIFICATIONS

Product	ID #	Chain Size Inches	Chain Size mm	Grade	Dim A (in.)	Dim B (in.)	Dim C (in.)	Dim D (in.)	Dim E (in.)	Dim F (in.)	Dim G (in.)	Dim H (in.)	Dim I (in.)	Dim J (in.)	Lbs. Per Ea.	Working Load Limit (Lbs.)
598800084	K-84	3/4	20	80	2.375	3.250	8.531	8.188	2.688	0.313	0.813	1.219	1.000	1.750	15.2	28300
598800085	K-85	7/8	22	80	2.750	3.656	9.625	9.469	3.000	0.375	0.938	1.281	1.063	2.000	25.9	34200
598850080	K-80	9/32	7	100	1.000	1.500	3.313	3.625	1.125	0.125	0.313	0.406	0.344	0.625	1.3	4300
598850081	K-81	3/8	10	100	1.281	2.031	4.781	4.813	1.625	0.156	0.438	0.563	0.469	0.875	3.1	8800
598850082	K-82	1/2	13	100	1.688	2.438	6.125	6.125	2.000	0.188	0.563	0.750	0.656	1.125	6.5	15000
598850083	K-83	5/8	16	100	1.938	2.875	6.813	7.219	2.438	0.250	0.688	0.938	0.813	1.500	10.7	22600
599800086	K-86	1	26	63	2.688	4.063	10.063	10.063	3.375	---	1.375	1.219	1.094	1.875	26.9	35900