

KUPLEX® CLEVIS GRAB HOOKS

The Kuplex® Clevis Type Grab Hook is an excellent choice for overhead lifting and is also suitable for tie down or other applications. The Canadian made cradle grab hook is a reliable choice as it meets the latest guidelines of the NACM and ASTM A391/A391M (Grade 80) or ASTM A973/A973M (Grade 100).



KUPLEX® CLEVIS GRAB HOOKS

GRADE

- 80 and 100

FINISH

- Powder coated red

STANDARDS

- Meet the latest guidelines of the NACM and ASTM A391/A391M (Grade 80) or ASTM A973/A973M (Grade 100)

ATTACHMENT

- Clevis

HEAT TREATMENT

- Quenched and tempered before proof testing

ORIGIN

- Made in Canada

HOOK TYPE

- Grab Hook

APPLICATION

- Overhead Lifting

MATERIAL

- Premium quality, high strength alloy steel

KUPLEX® CLEVIS GRAB HOOKS

DIAGRAM DRAWINGS

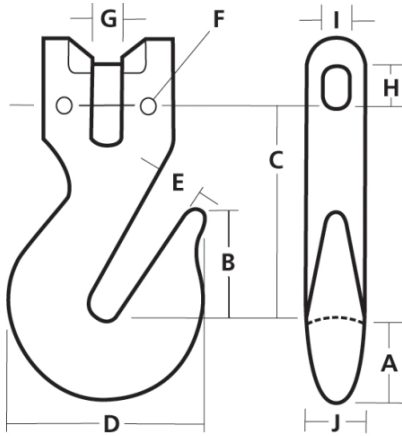

KUPLEX® CLEVIS GRAB HOOKS

PRODUCTS SPECIFICATIONS

Product	ID #	Chain Size Inches	Chain Size mm	Grade	Dim A (in.)	Dim B (in.)	Dim C (in.)	Dim D (in.)	Dim E (in.)	Dim F (in.)	Dim G (in.)	Dim H (in.)	Dim I (in.)	Dim J (in.)	Lbs. Per Ea.	Working Load Limit (Lbs.)
598700077	K-77	3/4	20	80	1.875	2.938	5.094	5.063	0.875	0.313	0.813	1.219	1.000	1.750	10.1	28300
598700078	K-78	7/8	22	80	2.125	3.500	5.875	6.094	1.125	0.375	0.938	1.281	1.063	2.000	14.8	34200
598750072	K-72	9/32	7	100	0.688	1.250	2.125	2.125	0.375	0.125	0.313	0.406	0.344	0.625	0.6	4300
598750073	K-73	3/8	10	100	1.031	1.500	2.875	2.625	0.500	0.156	0.438	0.563	0.469	0.875	1.5	8800
598750075	K-75	1/2	13	100	1.25	2.000	3.563	3.344	0.625	0.188	0.563	0.750	0.656	1.125	3.4	15000
598750076	K-76	5/8	16	100	1.625	2.375	4.313	4.250	0.781	0.250	0.688	0.938	0.813	1.500	6.2	22600